

DR SPARE PARTS Male Configuration

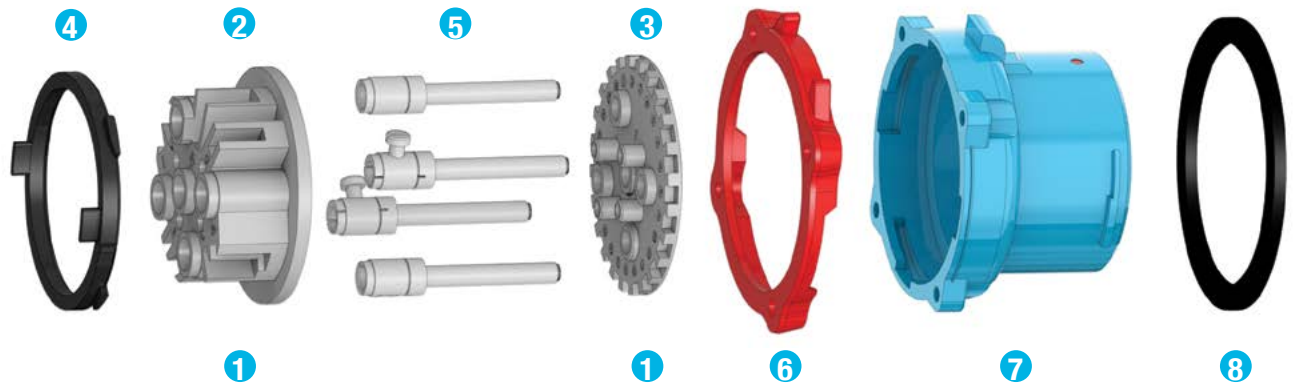

		DR30 POLY	DR50 POLY	DR100 POLY	DR100 METAL	DR150 POLY	DR150 METAL	DR250 METAL	DR400 METAL	
1	Plug Interior***	31-1A010*	31-3A010*	31-6A010*	31-6A010*	61-9A010*	69-9A010*	39-2A010*	-	
1	Plug Interior w/Ground Contacts***	-	-	-	39-6A110*	-	69-9A110*	39-2A110*	-	
1	Plug Interior with 2 Pilots+	31-1A310-972*	31-3A310-972*	31-6A310-972*	31-6A310-972*	61-9A310-262*	61-9A310-262*	39-2A310-172*	39-4A310-172*	
2	Interior Bottom***	31-1A010-B	31-3A010-B	31-6A010-B	31-6A010-B	61-9A551	69-9A551	39-2A010-B	39-4A010-B	
3	Interior Top***	31-1A010-T*	31-3A010-T*	31-6A010-T*	31-6A010-T*	61-9A010-T*	69-9A010-T*	39-2A010-T*	39-4A010-T*	
4	Polyester Locking Ring	31-1A583	31-3A583	31-6A583	-	31-9A583	-	-	-	
4	Metal Locking Ring	-	-	-	39-6A583	-	39-9A583	39-2A583	39-4A583	
5	Plug Phase Contact (If no aux. contacts)	31-1A011-380	31-3A011-380	31-6A011	31-6A011	61-9A011	61-9A011	39-2A011	-	
5	Plug Phase Contact (If plug has aux. contacts)	31-1A011	31-3A011-380	31-6A011	31-6A011	61-9A011	61-9A011	39-2A011	39-4A011	
5	Plug Ground Contact	31-1A019	31-3A019	31-6A019	39-6A019	61-9A019	69-9A019	39-2A019	39-4A019	
6	Color-Coded Voltage Gasket	125V	31-1AC26	31-3AC26	31-6AC26	31-6AC26	31-9AC26	31-9AC26	39-2AC26	-
		208V	31-1AB26	31-3AB26	31-6AB26	31-6AB26	31-9AB26	31-9AB26	39-2AB26	-
		250V	31-1AC26	31-3AC26	31-6AC26	31-6AC26	31-9AC26	31-9AC26	39-2AC26	-
		480V	31-1AR26	31-3AR26	31-6AR26	31-6AR26	31-9AR26	31-9AR26	39-2AR26	-
		600V	31-1AN26	31-3AN26	31-6AN26	31-6AN26	31-9AN26	31-9AN26	39-2AN26	-
7	Plug Polyester Casing w/Plug Gasket	31-1A014**	31-3A014**	31-6A014**	-	61-9A014**	-	-	-	
7	Plug Metal Casing w/Plug Gasket	-	-	-	39-6A014**	-	39-9A014**	39-2A014**	39-4A014**	
8	Type 4X Gasket	31-1A056	31-3A056	31-6A066	39-6A066	-	31-9A066	39-2A056	-	

* Voltage and phasing positions must be specified (5th, 6th & 7th digit of Part #) to duplicate your shutter and alignment notches.

** For appropriate labeling on a device, please specify voltage, phasing, and product type.

*** For interiors with pilot contacts, contact Customer Service for part numbers.

+ For interiors with more than 2 pilot contacts, contact Customer Service for part numbers.

DR SPARE PARTS Female Configuration

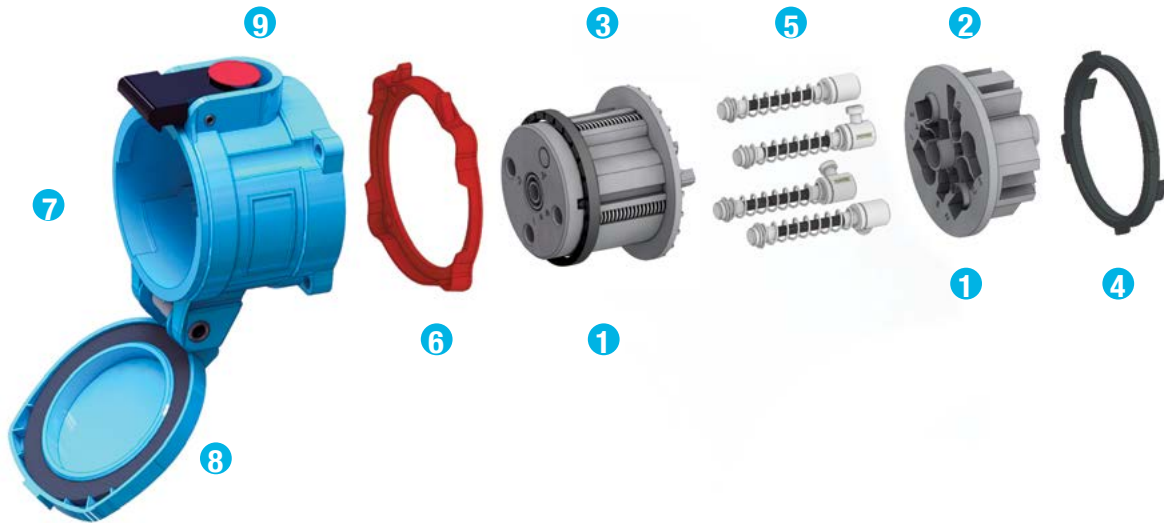

		DR30 POLY	DR50 POLY	DR100 POLY	DR100 METAL	DR150 POLY	DR150 METAL	DR250 METAL	DR400 METAL	
1	Receptacle Interior***	31-1A020*	31-3A020*	31-6A020*	31-6A020*	61-9A020*	69-9A020*	39-2A020-A06*	-	
1	Recept Interior w/Ground Contacts***	-	-	-	39-6A220*	-	69-9A220*	39-2A220-A06*	-	
1	Receptacle Interior with 2 Pilots+	31-1A320-972*	31-3A320-972*	31-6A320-972*	31-6A320-972*	61-9A320-262*	61-9A320-262*	39-2A320-172-A06*	39-4A320-172*	
2	Interior Bottom***	31-1A020-B	31-3A020-B	31-6A020-B	31-6A020-B	61-9A552	69-9A552	39-2A020-B-A06	39-4A020-B	
3	Interior Top***	31-1A020-T*	31-3A020-T*	31-6A020-T*	31-6A020-T*	61-9A020-T*	69-9A020-T*	39-2A020-T*	39-4A020-T*	
4	Polyester Locking Ring	31-1A583	31-3A583	31-6A583	-	31-9A583	-	-	-	
4	Metal Locking Ring	-	-	-	39-6A583	-	39-9A583	39-2A583	39-4A583	
5	Recept Phase Contact (If no aux. contacts)	31-1A021-380	31-3A021-380	31-6A021	31-6A021	61-9A021	61-9A021	39-2A021-A06	-	
5	Recept Phase Contact (If plug has aux. contacts)	31-1A021	31-3A021-380	31-6A021	31-6A021	61-9A021	61-9A021	39-2A021-A06	39-4A021	
5	Recept Ground Contact	31-1A029	31-3A029	31-6A029	39-6A029	61-9A029	69-9A029	39-2A029-A06	39-4A029	
6	Color-Coded Voltage Gasket	125V	31-1AC26	31-3AC26	31-6AC26	31-6AC26	31-9AC26	31-9AC26	39-2AC26	-
		208V	31-1AB26	31-3AB26	31-6AB26	31-6AB26	31-9AB26	31-9AB26	39-2AB26	-
		250V	31-1AC26	31-3AC26	31-6AC26	31-6AC26	31-9AC26	31-9AC26	39-2AC26	-
		480V	31-1AR26	31-3AR26	31-6AR26	31-6AR26	31-9AR26	31-9AR26	39-2AR26	-
		600V	31-1AN26	31-3AN26	31-6AN26	31-6AN26	31-9AN26	31-9AN26	39-2AN26	-
7	Receptacle Polyester Casing w/Lid	31-1A024**	31-3A024**	31-6A024**	-	61-9A024**	-	-	-	
7	Receptacle Metal Casing with Lid	-	-	-	39-6A024**	-	39-9A024**	39-2A024**	39-4A024** ++	
8	Lid Replacement Kit Polyester	31-1A125	31-3A125	31-6A425	-	61-9A125	-	-	-	
8	Lid Replacement Kit Metal	-	-	-	39-6A925	-	39-9A925	39-2A925	-	
9	Pawl Replacement Kit Polyester	31-1A824	31-3A824	31-6A824	-	61-9A824	-	-	-	
9	Pawl Replacement Kit Metal	39-1A824	39-3A824	39-6A824	39-6A824	69-9A924	39-9A824	39-2A824	-	

* Voltage and phasing positions must be specified (5th, 6th & 7th digit of Part #) to duplicate your shutter and alignment notches.

** For appropriate labeling on a device, please specify voltage, phasing, and product type.

*** For interiors with 2 pilot contacts, contact Customer Service for part numbers.

+ For interiors with more than 2 pilot contacts, contact Customer Service for part numbers.

** For DR 400 Drawbar Accessory contact Customer Service.